

Product data sheet

Specifications



Fixing plate for use on vertical support for modular tower lights, Harmony XVU, black, 60mm

XVUZ12

Main

Range of product	Harmony XVU
Product or component type	Modular tower light
Accessory / separate part type	Fixing plate
Accessory / separate part category	Mounting and fixing accessory
Component name	XVU
Mounting diameter	60 mm

Complementary

Mounting support	Wall mounted
Product compatibility	XVUZ05 XVUZ800 XVUZ400 XVUZ02Q XVUZ02
Material	Aluminium V-0 conforming to UL 94
Housing colour	Black
[Us] rated supply voltage	24 V AC/DC 110...240 V AC
Length	8 mm
Product weight	0.36 kg

Environment

Ambient air temperature for storage	-40...70 °C
Ambient air temperature for operation	-25...50 °C
IP degree of protection	IP65
Product certifications	CSA UL CE

Packing Units

Unit Type of Package 1	PCE
Number of Units in Package 1	1

Package 1 Height	5.068 cm
Package 1 Width	6.844 cm
Package 1 Length	11.412 cm
Package 1 Weight	491.0 g
Unit Type of Package 2	CAR
Number of Units in Package 2	10
Package 2 Height	15.6 cm
Package 2 Width	15.3 cm
Package 2 Length	39.8 cm
Package 2 Weight	5.651 kg

Offer Sustainability

Sustainable offer status	Green Premium product
REACH Regulation	REACH Declaration
EU RoHS Directive	Pro-active compliance (Product out of EU RoHS legal scope) EU RoHS Declaration
Mercury free	Yes
China RoHS Regulation	China RoHS declaration
RoHS exemption information	Yes
Environmental Disclosure	Product Environmental Profile
Circularity Profile	End of Life Information
California proposition 65	WARNING: This product can expose you to chemicals including: Lead and lead compounds, which is known to the State of California to cause cancer and birth defects or other reproductive harm. For more information go to www.P65Warnings.ca.gov

Dimensions

Rear View

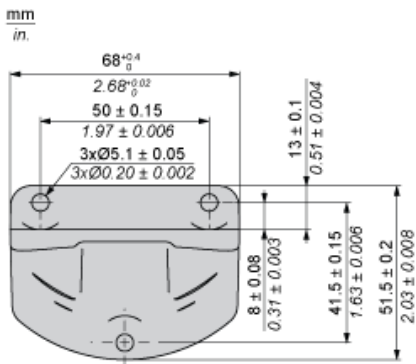

Side View

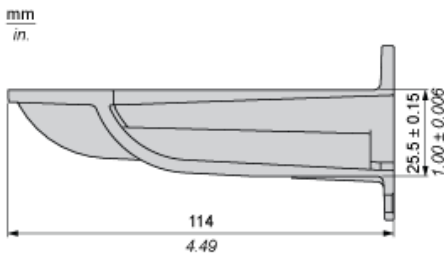

Vertical Support Panel Drillings

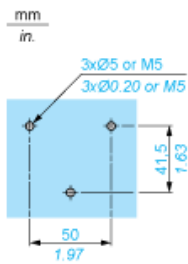

Recommended replacement(s)